

3 way ball valve, 9SMnPb36, "L" or "T" port, diverting only, F/F/F threaded, for high pressure, with pneumatic actuator. For hydraulic oil, emulsion, gas. For particular applications, refer to sales department.

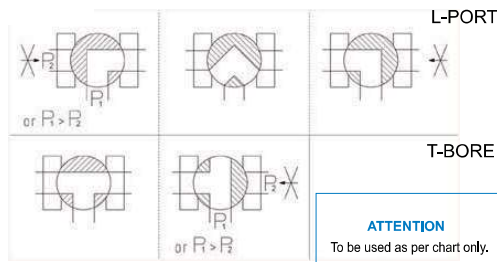
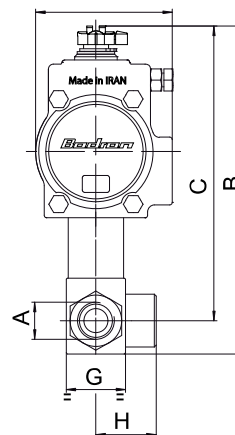
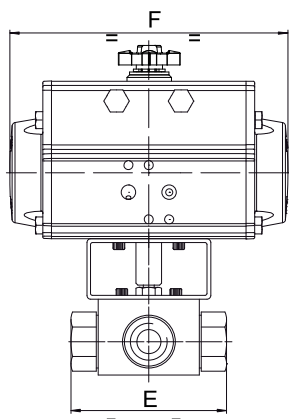

Art. 8P015300 (L) 8P015400 (T)

Valve With Double Acting Actuator

PN	400	350	350	350
DN - A	3/8"	1/2"	3/4"	1"
B	182	196	226	236
C	164	178	203	207
D	71	81	95	95
E	73	83	95	112
F	141	164	210	210
G	35	37	45	55
H	37	40	52	60
ACT.	DA 52	DA 63	DA 75	DA 75
RI	3740	3741	3742	3742

Art. 8P015500 (L) 8P015600 (T)

Valve With Spring Return Actuator

PN	400	350	350	350
DN - A	3/8"	1/2"	3/4"	1"
B	211	214	253	263
C	194	196	230	234
D	95	95	123	123
E	73	83	95	112
F	210	210	275	275
G	35	37	45	55
H	37	40	52	60
ACT.	SR 75	SR 75	SR 100	SR 100
RI	3745	3745	3742	3742

Actuator air supply pressure minimum 6 Bar