

3 way ball valve, AISI 316L, "L" or "T" port, diverting only, F/F/F threaded, for high pressure, with pneumatic actuator. For hydraulic oil, emulsion, gas. For particular applications, refer to sales department.

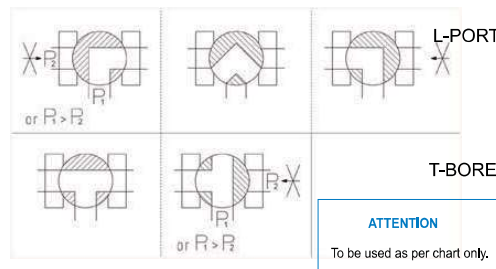
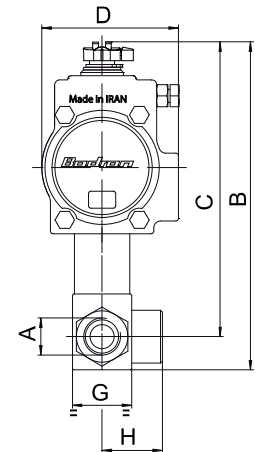
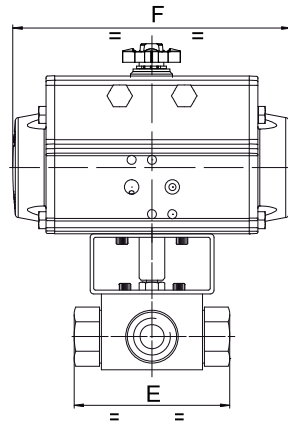

**Art. 8P023500 (L) 8P023600 (T)**

Valve With Spring Return Actuator

| PN     | 400   | 350   | 350    | 350    |
|--------|-------|-------|--------|--------|
| DN - A | 3/8"  | 1/2"  | 3/4"   | 1"     |
| B      | 211   | 214   | 253    | 263    |
| C      | 194   | 196   | 230    | 234    |
| D      | 95    | 95    | 123    | 123    |
| E      | 73    | 83    | 95     | 112    |
| F      | 210   | 210   | 275    | 275    |
| G      | 35    | 37    | 45     | 55     |
| H      | 37    | 40    | 52     | 60     |
| ACT.   | SR 75 | SR 75 | SR 100 | SR 100 |
| RI     | 3745  | 3745  | 3742   | 3742   |

**Art. 8P023300 (L) 8P023400 (T)**

Valve With Double Acting Actuator

| PN     | 400   | 350   | 350   | 350   |
|--------|-------|-------|-------|-------|
| DN - A | 3/8"  | 1/2"  | 3/4"  | 1"    |
| B      | 182   | 196   | 226   | 236   |
| C      | 164   | 178   | 203   | 207   |
| D      | 71    | 81    | 95    | 95    |
| E      | 73    | 83    | 95    | 112   |
| F      | 141   | 164   | 210   | 210   |
| G      | 35    | 37    | 45    | 55    |
| H      | 37    | 40    | 52    | 60    |
| ACT.   | DA 52 | DA 63 | DA 75 | DA 75 |
| RI     | 3740  | 3741  | 3742  | 3742  |

Actuator air supply pressure minimum 6 Bar