

Flanged PN16 stainless steel AISI 316-CF8M ball valve, full bore "SPLIT BODY" type [art. 765000] ISO 5211 pad direct, fire safe, antistatic device, EN558 basic series 27 face to face dimension, with electric actuator series 85. (Self-Extinguish Technopolymer Enclosure)

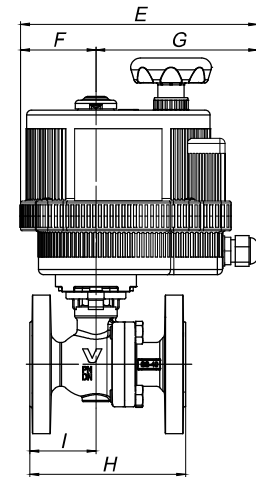
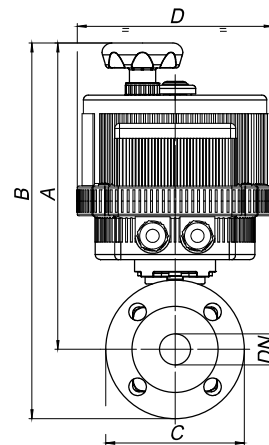

Art. 8E185***

DN	25	32	40	50	65	80	100
PN	40	40	40	40	16	16	16
A	246	286	295	305	343	352	367
B	304	356	370	387	436	452	477
C	115	140	150	165	185	200	220
D	157	185	185	185	211	211	211
E	191	215	215	215	237	237	237
F	61	68	68	68	84	84	84
G	130	147	147	147	153	153	153
H	125	130	140	150	170	180	190
I	53	55	52	58	63	76	80
ACT.	VB 30	VB 60	VB 60	VB 60	VB 110	VB 110	VB 190
RI	4579	4580	4581	4581	4584	4584	4586

*** VOLTAGE SUPPLY ORDER CODE		
12V AC/DC	24V AC/DC	100-240V AC
+ 001	+ 002	+ 004