

Declutchable Gear Operator



GENERAL CHARACTERISTICS

Item	Description	Material
Aluminium housing	Actreg's direct mounting	User-friendly
Rugged construction	Compact design – low weight	Double adjustment stroke
Sealed to IP-65	Integral top flange	ISO 5211 double drilling

DG-50

BADRAN direct mounting Double Acting Actuator

ADA 0020 F05 / ADA 0040 F05

ADA 0080 / ADA 0130

ADA 0200

BADRAN direct mounting Single Acting

ASR 0020 F05 / ASR 0040 F05

ASR 0080 / ADA 0130

DG-102

BADRAN direct mounting Double Acting Actuator

ADA 0500 / ADA 300

ADA 0850

BADRAN direct mounting Single Acting

ASR 0300

ASR 0500

DG-140

BADRAN direct mounting Double Acting Actuator

ADA 1200

ADA 1750

BADRAN direct mounting Single Acting

ASR 0850

DG-165

BADRAN direct mounting Double Acting Actuator

ADA 1200

ADA 1750

ADA 2100

BADRAN direct mounting Single Acting

ASR 1200

ASR 1750

DG-254

BADRAN direct mounting Double Acting Actuator

ADA 2100

ADA 2500

ADA 4000

BADRAN direct mounting Single Acting

ASR 2100 (*)

ASR 2500 (*)

ASR 4000 S08

(*)Calculated with maximum springs sets

NOTE: This sizing sheet is given only as a guidelines

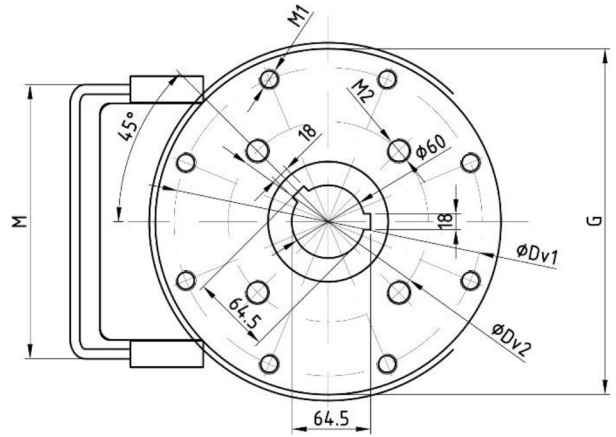
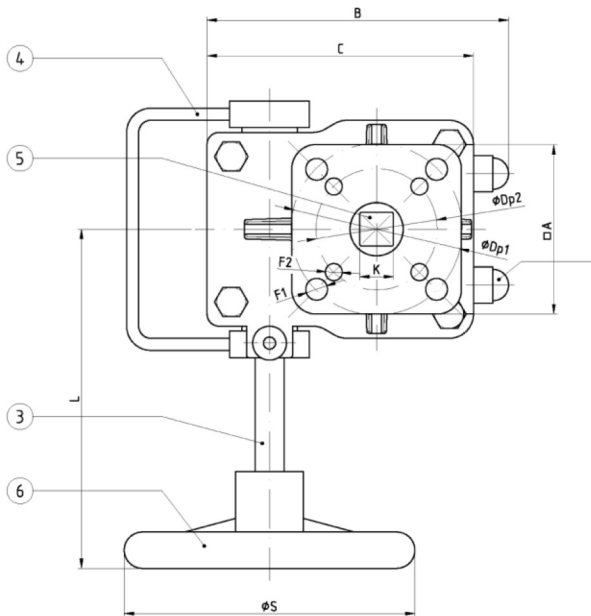
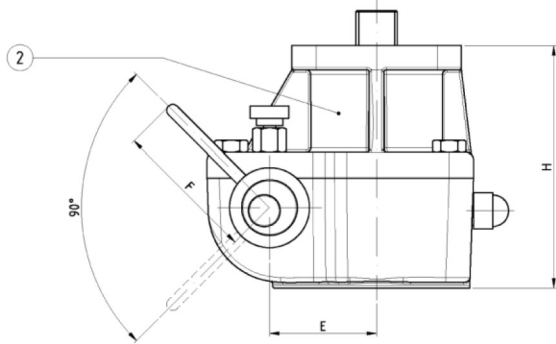
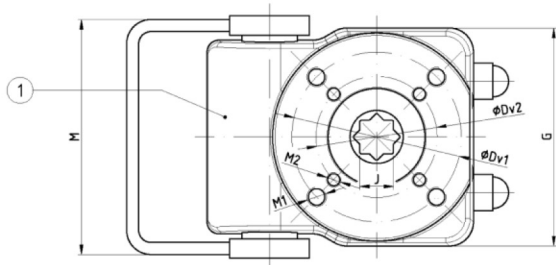

ONLY DG-254

CONSTRUCTION

Item	Description	Material
1	Body	Aluminium Alloy
2	Cover Plate	Aluminium Alloy
3	Shaft	Carbon Steel
4	Lever	Carbon Steel
5	Join Shaft	Carbon Steel
6	Handwheel	Carbon steel Epoxy painted
7	Nut protection cup	NBR
	Worm	Ductil Iron
	Worm Gear	Carbon Steel
	Screws	Steel

DIMENSIONS

Model	Gear Ratio	Output Torque	A	B	C	E	F	Dp1	F1	Dp2	F2	Dv1	M1	Dv2	M2	J	K	G	H	L	M	ØS	Weight (Kg)
DG-050	1:40	300 Nm	70	125	110	44	54	70 (F07)	8.5	50 (F05)	6.5	70 (F07)	M8	50 (F05)	M6	17	14	90	100	130	104	200	2.3
DG-102	1:36	810 Nm	115	185	160	65	70	125 (F12)	13	102 (F10)	11	125 (F12)	M12	102 (F10)	M10	27	22	140	124	180	140	300	5.6
DG-140	1:50	1310 Nm	140	230	210	85	78	140 (F14)	17	102 (F10)	11	140 (F14)	M16	--	--	36	27	190	162	300	180	400	12.5
DG-165	1:55	2800 Nm	165	268	243	105	105	165 (F16)	21	140 (F14)	17	165 (F16)	M20	--	--	36	36	230	181	385	210	600	25.8
DG-254	1:50	5500 Nm	Ø295	330	283	130	115	254 (F25)	17	165 (F16)	21	254 (F25)	M16	165 (F16)	M20	Ø60	46	285	205	400	225	700	40.3

(*) Only for serie ASR.

Data given can be changed without notice.